

PRECISION/GROUND FACE/SHOT BLAST

All Precision CMUs are in stock unless indicated by (Special Order) below each drawing.
 All Ground Face and Shot Blast CMUs are special order

16" Wide Wall 8" High Units

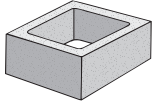

16 x 8 x 16
Single Cell Unit

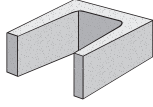

16 x 8 x 16
"U" Beam
(Special Order)

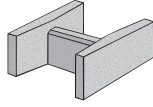

16 x 8 x 16
Double Open End
Bond Beam

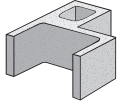

16 x 8 x 16
Open Center Pilaster
(Special Order)

Dimensions and Size Note:

All CMUs are described in Nominal Dimensions (the actual measurement plus the thickness of the mortar joint)
 Actual measurements are "specified" dimensions. See example below

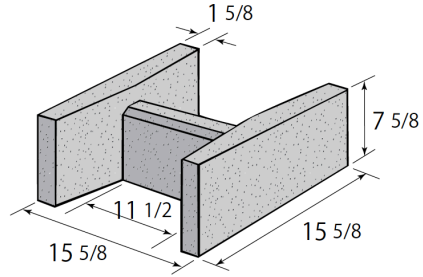

Nominal:
16" x 8" x 16"
 Specified:
15 5/8" x 7 5/8" x 15 5/8"